

C01 Extremely Thin Linear LED Light



LAMP



USE1



USE2



USE3



Plastic connector



Connector cable

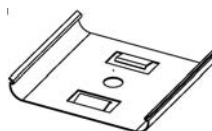

Mounting Clip



Led power supply



DC receptacle

CLEDLIGHT's **C01** Linear-Led Light is widely used in **showcases, display case** or **furniture**. This extremely Thin Linear LED Light is especially applied to hidden/ covert installation. After processed by special optical system, which has patented, this kind of extremely thin linear light indeed becomes a continuous / real linear light source. By using connector cable and/or plastic connector, a few lamps can be installed in a row quickly and easily. The single Linear-LED Light comes in three different sizes (L=300mm/500mm/1000mm)

Benefits

- Energy saving up to 50% compared with traditional fluorescent under the same flux
- Life Span—over 50,000 hours
- Available in cool white, neutral white, and warm white color temperatures; Available in other colors
- Easy linking up to 36 watts per run
- Easy installation
- Low voltage, more safety.

Applications

LED show case lighting; LED shelf lighting; LED under counter lighting; LED display case lighting; LED retail product Lighting; LED Furniture Lighting; LED bookcase lighting; LED wardrobe lighting; LED wine cabinet lighting; LED under cabinet lighting; LED kitchen cabinet lighting; LED cove lighting; LED accent lighting; LED task lighting; LED product line lighting

Technical Operating Data

Product	length	Number of leds	Voltage	Power	Radiance	Color Temp.	Luminous Flux	Led Current
	[mm]	[pcs]	[V DC]	[W]	Angle [°]	[K]	[lm]*	[A]
C01L1	L=300	42	12/24	3	90	2700-6500k	250	0.18
C01L2	L=500	72	12/24	5	90	2700-6500k	420	0.18
C01L3	L=1000	144	12/24	11	90	2700-6500k	820	0.18

Technical Features

Dimensions: 33mm (width) x 8mm (height) x “L”

Materials: Aluminum extrusion with black plastic end caps, Acrylic Lens

Light Source: High brightness SMD3528 LED

Operating Temperature: -20°C to 40°C - Indoors

Warranty: 2 years with proper installation and power supply

Installation: 2 Mounting Clips and 2 M2.6x10 screws make it easy to install

Packing Information:

Product	Color box* size	Carton size	Units/carton	Net weight	Gross weight
C01L1	450X36X12	470(length) X120 (width) X230 (height)	40	7.2	7.6
C01L2	650X36X12	670(length) X120 (width) X230 (height)	40	10.5	11.0
C01L3	1150X36X12	1170(length)X120(width)X230(height)	40	18.0	19.0
Power supply(6w)	76X61X46	250(length) X170 (width) X270 (height)	40	2.5	3.0
Power supply(12w)	136x58x77	315(length) X290 (width) X340 (height)	40	8.4	8.9
Power supply(24w)	136x58x77	315(length) X290 (width) X340 (height)	40	10.0	10.5
Power supply with DC receptacle(24w)	136x58x77	315(length) X290 (width) X340 (height)	40	11.0	11.5

- Note: 1) Each Co1 color box includes 1lamp, 2 Mounting Clip, 2 M2.6x10 screws, 1 manual. (1 Plastic connector, 1 Connector cable is optional)
- 2) You can choose different power supply and accessories according to the power supply usage instruction,

Power supply usage instruction

The following table shows how many lamps the power supply can drive respectively. You can select suitable power supply according to the power per run.

Power Supply	C01L1	C01L2	C01L3
6W	2	1	XXX
12W	4	2	1
24W	8	4	2
36W	12	6	3

Note: 1) The power supply's power should be over the total power when lamps are linked up.

Safety Information

- 1) Indoor use only
- 2) LED Module incorporates no protection against short circuits, overload or overheating. Therefore it is absolutely necessary to operate the modules with an electronically stabilised power supply offering protection against the above mentioned safety risks. Our power supply is specifically designed with protection features for safe operation. When using power supply other than us, the following basic safety features are required, in addition to any other application specific concerns and local safety codes:

- Short circuit protection Overload protection Overheat protection

Drawing

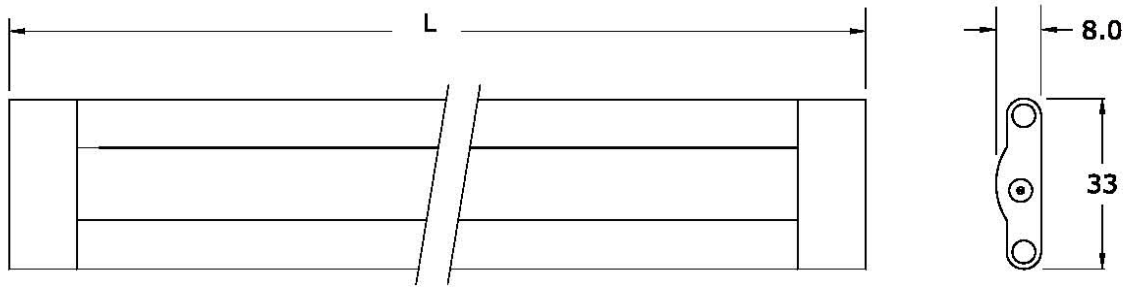

You will need a additional clearance at one or both ends to plug in power cord and/or linking extension(s).

Installation information:

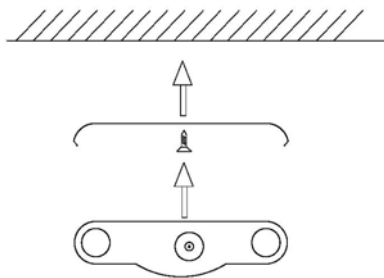

Complete set connection guide:

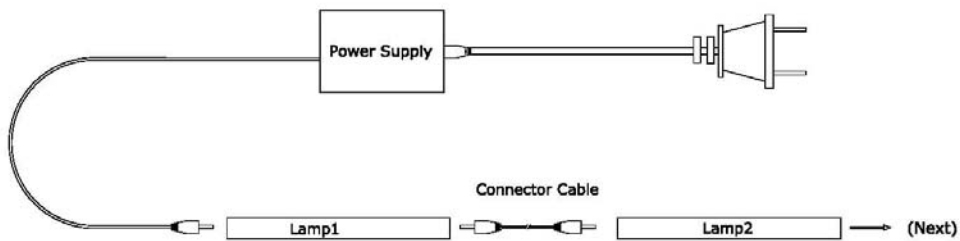

Connection 1 (A certain distance between lamps)

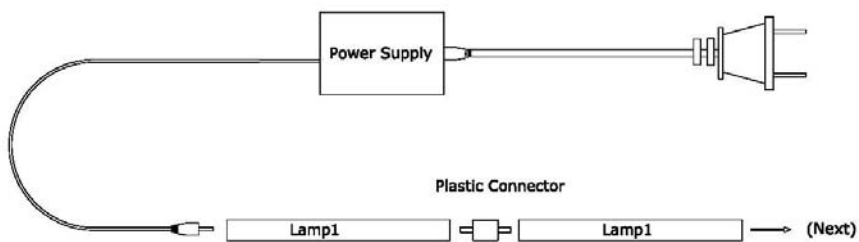

Connection 2 (Connected in a row without clearance)

电光源测试报告

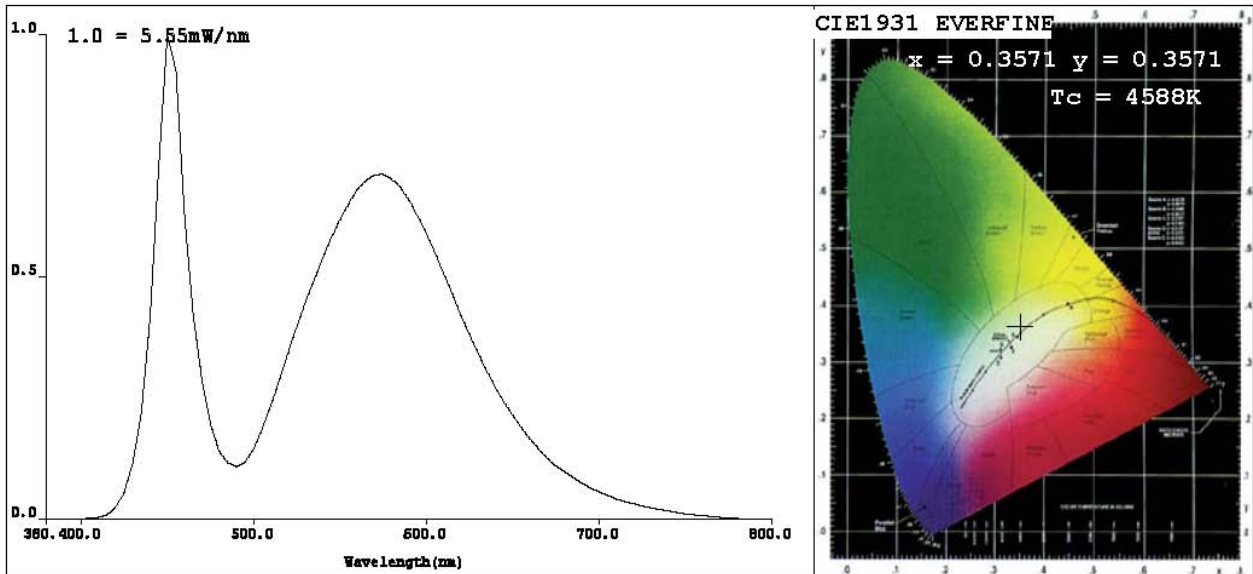

CIE颜色参数：

色品坐标: $x=0.3571$ $y=0.3571/u=0.2174$ $v=0.3261$ (duv=-1.86e-003)
 相关色温: $T_c=4588K$ 主波长: $\lambda_d=578.0nm$ 色纯度:Purity=14.3%
 峰值波长: $\lambda_p=450nm$ 半宽度: $\Delta\lambda_p=21.7nm$ 色比:R=14.3% G=82.5% B=3.1%
 平均波长: $\lambda_{av}=560nm$

显色指数:Ra=70.6

R1 =62 R2 =76 R3 =84 R4 =61 R5 =62 R6 =63 R7 =79 R8 =46
 R9 =-53 R10=41 R11=51 R12=30 R13=65 R14=91 R15=58

光参数：

光通量: $\Phi=208.48$ (lm) 光效率: $\eta=65.91$ (lm/W) 光辐射功率 $P=598.8$ (mW)

电参数：

U=24.00V I=0.1318A P=3.163W PF=1.000

仪器状态：

扫描范围:380.0nm-800.0nm 扫描间隔:5.0nm 主通道峰值: $I_p=12394$ (G=2, D=63)
 参考通道:REF=17595 最大波动:%=-0.011% 倍增管工作温度:29.0℃

产品型号:C01L1
 测试仪器:远方PMS-50
 环境温度:27.9℃
 测试人员: 邓希林

制造厂商: CLEDLIGHT
 系统测试单位: CLEDLIGHT
 环境湿度:65.0%
 测试日期:2009-05-25 16:10