

- Accuracy: $\pm 10\%$; Repeatability: $< \pm 2\%$
- Measuring range: 1.5~25 Liter/min
- Thread connection($\frac{1}{2}$ " BPS), easily installation



SPECIFICATION

- ◆ Accuracy: $\pm 10\%$ from scale value
- ◆ Repeatability: $\pm 2\%$ from scale value
- ◆ Range: 1.5~25 Liter/min
(H₂O at 22°C)
- ◆ Sensing Principle: Hall-Effect
- ◆ Max. Operating Pressure: 1 Mpa
- ◆ Max. O/P Current (at 24V): 8mA
- ◆ Burst Pressure (at 22°C): >15 bar
- ◆ Output Signal: Open Collect
- ◆ Operating Temperature: -20~80 °C
- ◆ Power Supply: 2.4~26VDC
- ◆ Wiring Cable: Round cable
3x0.14 mm²LIYY
- ◆ Protection: IP65

ORDER INFORMATION

GF51 - Code1 - Code2

Code1 Flow Range	
002	1.5~2.0 L/min
045	2.0~4.5 L/min
012	4.5~12.0 L/min
025	12.0~25.0 L/min
Code2 Wire Length	
N	1.5M
5	5M
10	10M
O	Option

DIMENSION

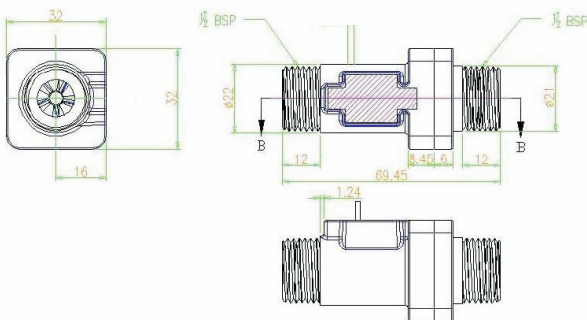

WIRING CONNECTION

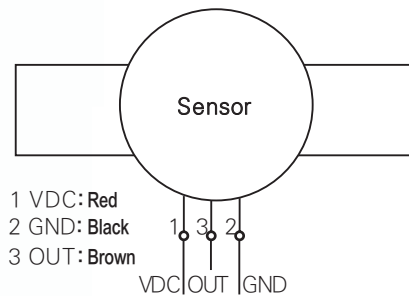

MATERIAL FEATURES

Materials	POM-Version
Housing	Nylon66
Impeller	POM
Stick of Turbine	SUS 304 Stainless Steel
Process Connection	1/2" BSP

K FACTOR TABLE

Flow Range (L/min)	Vertical	Horizontal
1.5~2.0 L/min:	277	230
2.0~4.5 L/min:	270	263
4.5~12.0 L/min:	263	263
12.0~25.0 L/min:	263	263